

# Vision S Laptop Support - Information and Instruction Sheet

Our Vision S laptop support has been designed to fit our newly designed Vision S monitor arm (sold separately), which offers the ergonomic benefits of an assisted monitor arm but is much more affordable.

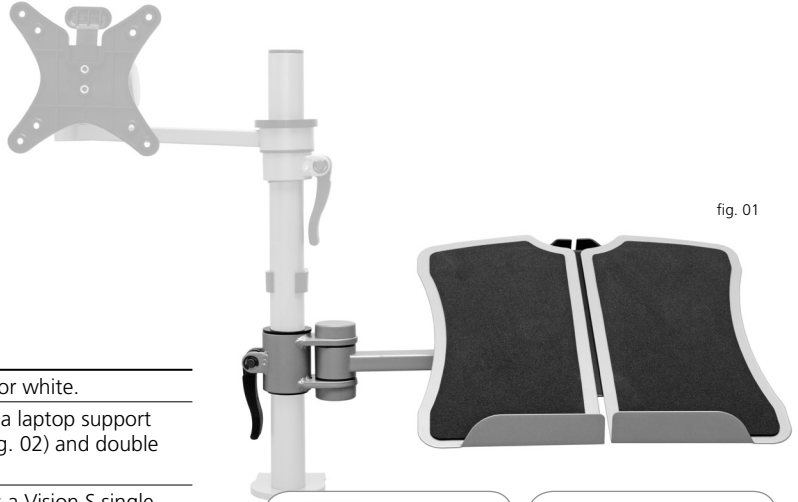

fig. 01

## Main features

1. Choice of silver, black or white.
2. Vision S is available as a laptop support (fig. 01), single arm (fig. 02) and double arm (fig.03).
3. The laptop support fits a Vision S single monitor arm (sold separately).
4. Vision S has a newly designed cable management clip to secure cables to the laptop support and pole.
5. Supports laptops up to 6kgs.



fig. 02

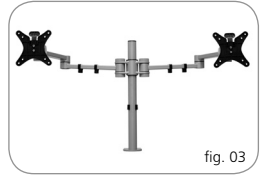

fig. 03

## Dimensions

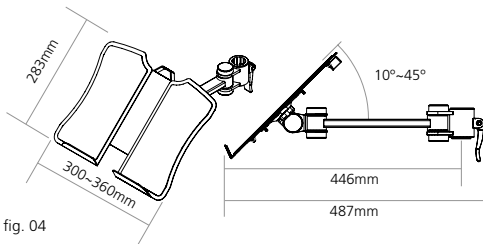
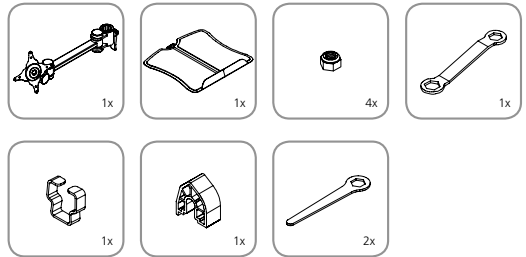

fig. 04

## Contents



# Vision S Laptop Support - Information and Instruction Sheet

## Fixing Instructions

1. The laptop support must be assembled before use.
2. Place the adjustable laptop tray face down and attach the back support with the two hand-tightening fixing nuts supplied (fig. 05).
3. The assembled laptop support must then be attached to the VESA on the arm section using the four nuts provided (fig. 06).
4. The cable management clip and laptop support locking clip can then be installed. Care should be taken to ensure the locking clip is fitted correctly (fig. 07).
5. The fully assembled laptop support can now be installed on the Vision S pole by lifting the lever before sliding the arm onto the pole to the desired height and pushing the lever down to secure into position (fig. 08).
6. The laptop support head assembly can be adjusted to support laptops of different weights (fig. 09).

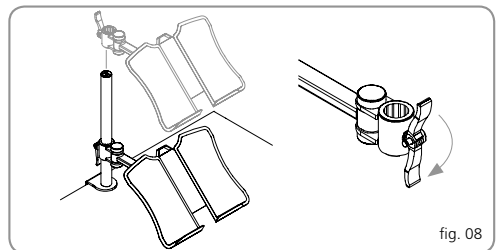
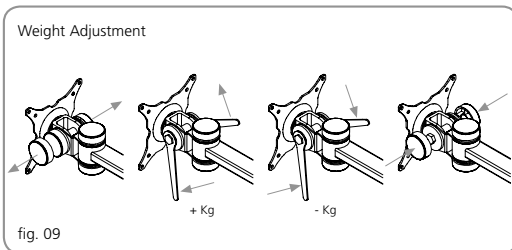
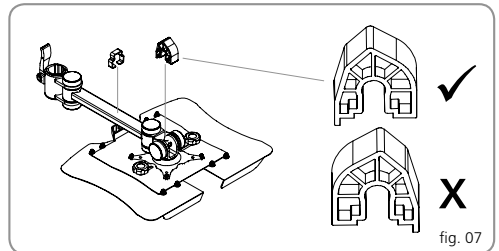
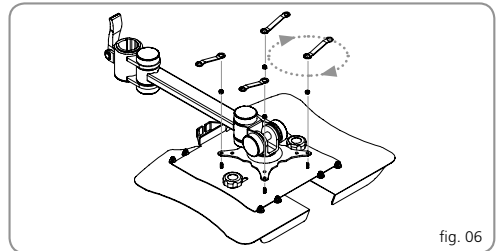
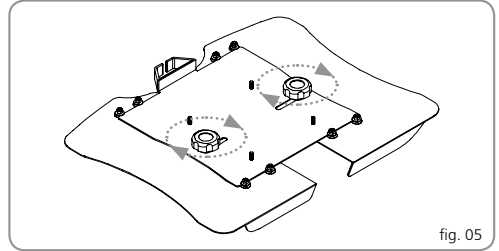

## Cleaning, Storage and Maintenance

Service Components	Available to order.
Cleaning & Maintenance	Dry cloth, no abrasives or solvents to be used on the product surface.
Handling & Storage	Do not drop.

## Warning

Do not exceed the recommended maximum weight.  
We recommend using the C clamp and through desk spreader pads to improve grip and protect the desk surface.